

two bedroom + den 1,011 sq.ft.

312, 403, 512, 603
712, 803, 912
balcony 167 sq.ft.
total 1,178 sq.ft.

303, 412, 503, 612
703, 812, 903
balcony 117 sq.ft.
total 1,128 sq.ft.

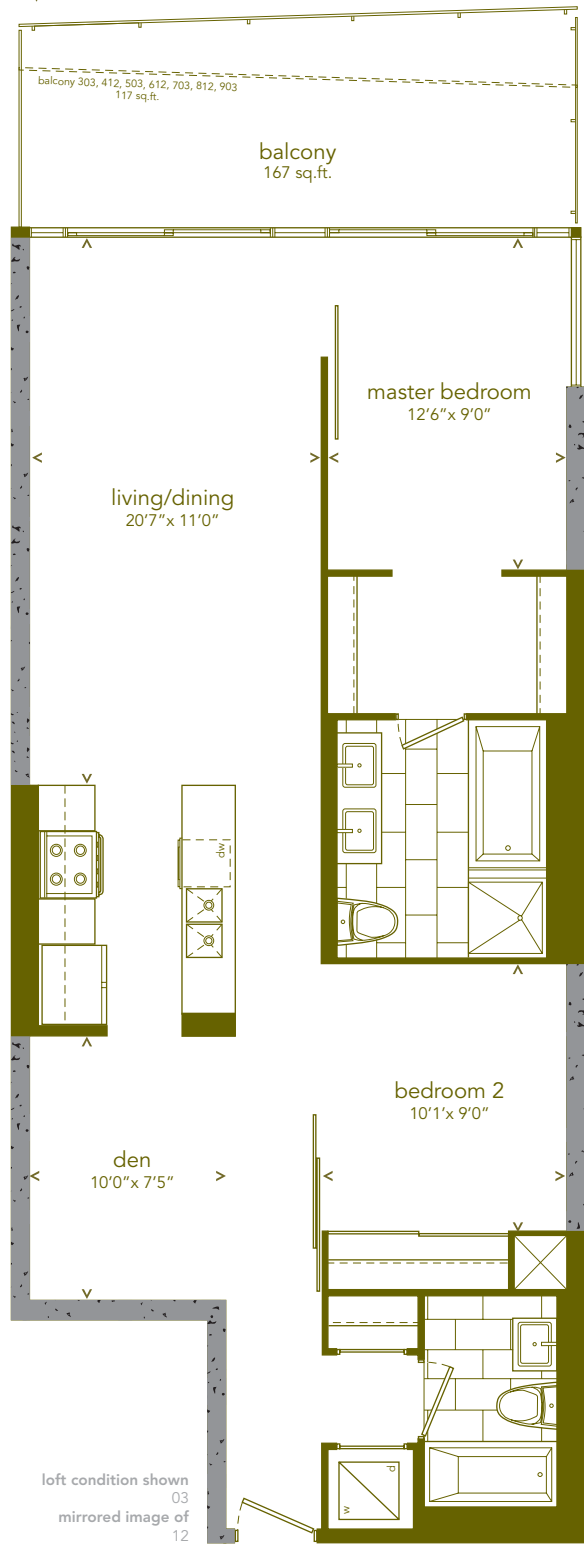

Actual usable floor spaces may vary from the stated floor area. E.801.E.



STADTPARK, VIENNA

Stadtspark was designed by painter Joseph Selleny and garden director Rudolf Siebeck in the 1860's. It is known as the Viennese City Park and acts as a link between the city centre and the Third District. The park offers prime examples of Viennese Art Nouveau with the Stadtbahn railway pavilions; however the most impressive structure in the park is the Kursalon Wien, an exquisite palace designed in the Italian Renaissance style and known for being a popular venue for composer Johann Strauss. In fact, amongst the formal gardens and green meadows of the park there is a famous monument dedicated to the composer.

levels 3-9

